

Quick Operation Guide

Angel-B-CN430B+
In-The-Ear hearing aid

Please read the rehabilitation plan first

Hearing Aid

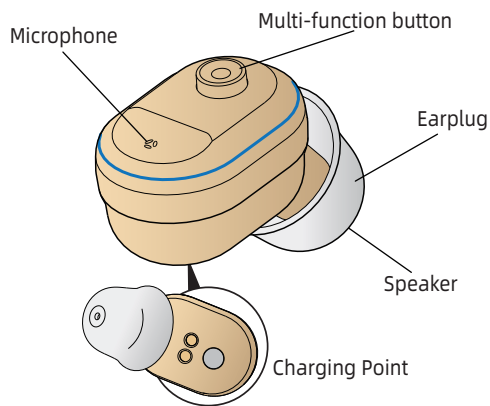

Charging Box

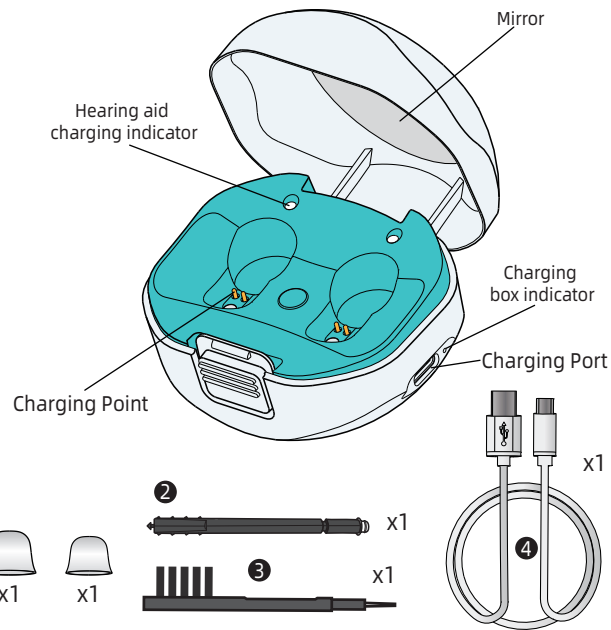

Accessories

- ① Earplugs s\m\l
- ② Cleaning brush
- ③ Wax Guard
- ④ Charging Cable

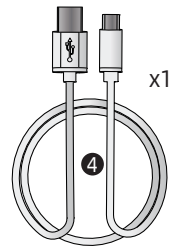
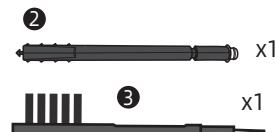
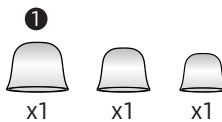

Technical Parameter

Max.OSPL90	HF Avg.OSPL90	Max gain	HFA Gain
≤107±3dB	104±3dB	31±4dB	28±4dB
Noise Level	Frequency Range	Battery Current	Total Distort
≤32dB	500-4000Hz	≤2mA	≤3%

Power On/Off

- Power ON: Take the device out of the charging box.
- Power OFF: Put the device into the charging box.

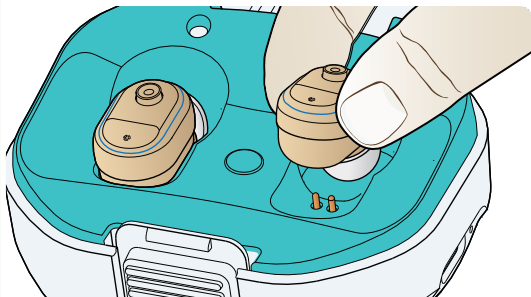

Please distinguish the right ear and the left ear according to the color. Blue for the left and red for the right.

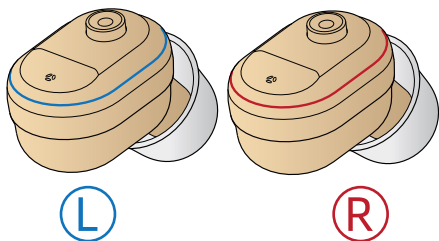

Note: For the first use, please remove the film from the device.

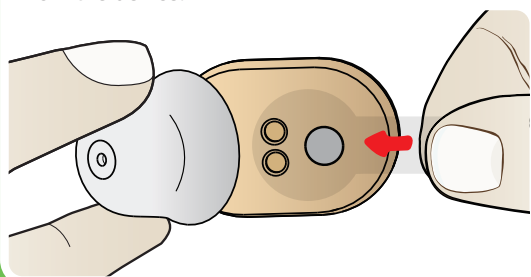

How to replace ear tips

At the time of purchase, an M size ear tip is attached. If it does not fit your ears, the sound is difficult to hear, or you hear beeping, replace the ear tips with the supplied S size or L size.

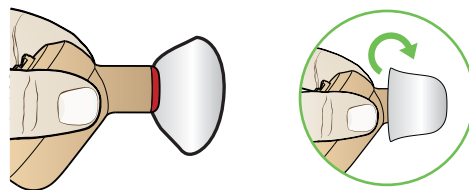

Turn the umbrella part of the ear tip over

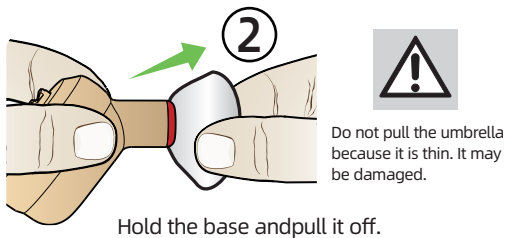

Hold the base and pull it off.

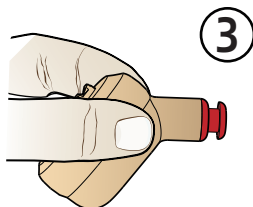

Hold the hearing aid with your hand.

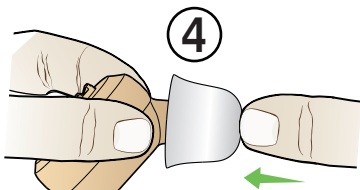

Insert the ear tip straight and insert it gently as far as it will go.

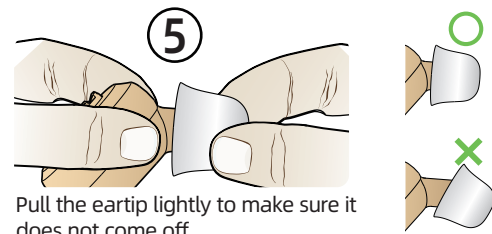

Pull the ear tip lightly to make sure it does not come off

How to use

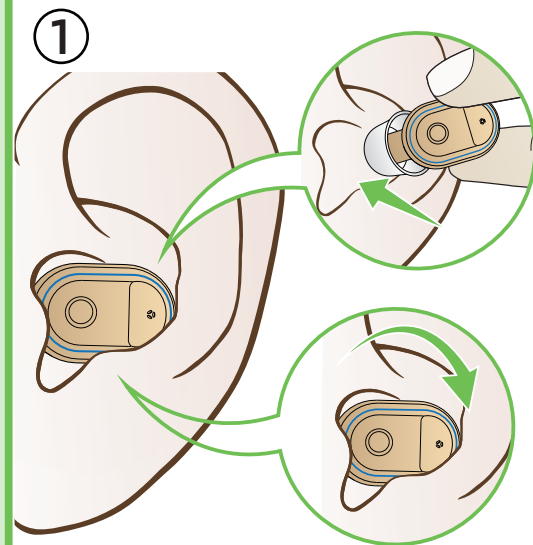

Pinch the hearing aid with your thumb and index finger, and place the earplug side in the ear canal. Rotate the hearing aid to snap it into the ear.

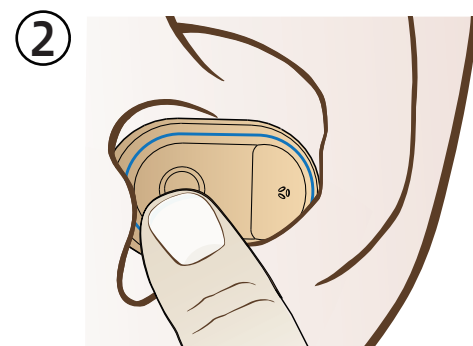

● Click the hearing aid button once: increase the volume by one level. Two beeps are heard, which is the highest volume level.

● Long press the hearing aid button for 3 seconds: One beep means simulation scene 1 (general mode). Two beeps mean simulation scene 2 (noise reduction). Three beeps mean simulation scene 3 (outdoors).

The hearing aid has a memory function, and there is no need to repeatedly adjust the volume and mode next time.

Bluetooth mode

Connection guide

Please fully charge the hearing aid first.

Step 1:

Make sure the hearing aid is turned on .

Step 2:

Open "Settings" on your mobile device.

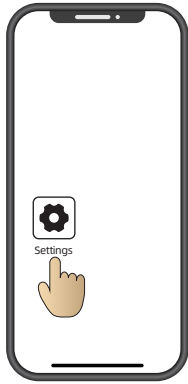

Step 3: Turn on the Bluetooth function of the phone, and search for Bluetooth devices to find the name of "Angel" , and then click "connect" to complete the connection.

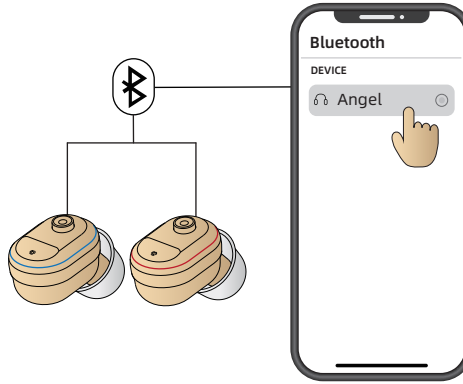

(Note: For paired devices, there is no need to re-pair them next time, because they can be automatically connected when turned on.)

1. The Bluetooth/hearing aid mode can be switched back and forth freely.

- Listen to music and incoming calls, and automatically switch the Bluetooth headset mode during a call.
- After the music is paused or the call is over, the phone will automatically switch to the hearing aid mode.
- When disconnected from the mobile phone, it will automatically switch to hearing aid mode.

2. If the hearing aid is not connected to the Bluetooth of the mobile phone for a long time, the Bluetooth function will be automatically turned off. Please restart your hearing aid and re-pair with your phone's Bluetooth.

3. Please keep it within 10 meters during use. Beyond this distance, the sound quality may deteriorate and the connection may be lost.

Low battery reminder

There are low battery warning signal beep sounds every one minute until the battery runs out. So please charge the hearing aids when you hear the beep.

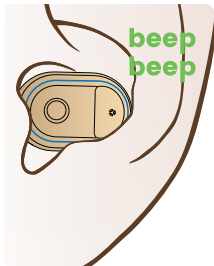

How to charge

Use the type-C data cable to connect the charging box, and plug the adapter into the power socket. Put the hearing aid into the Charging Box, and make sure the charging points are in good contact condition. They will automatically start to charge. The whole charging process is around 2 hours.

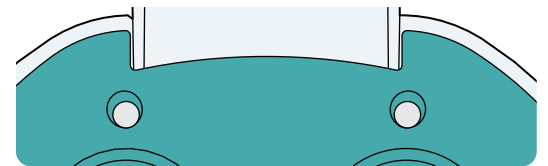
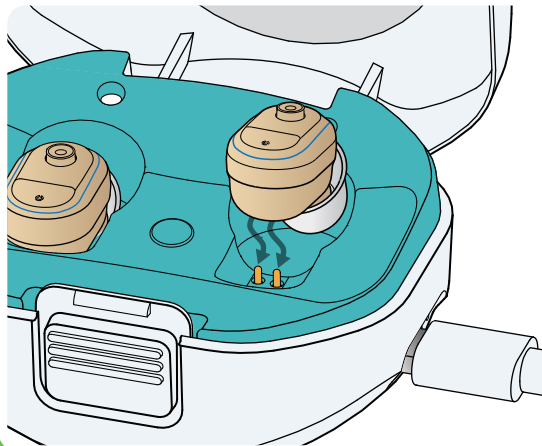

Hearing aid charging indicator

○ L	White light	○ R	○ L	Lights off	○ R
Charging			Full charged		

How to replace the earwax guard

Please replace the ear guard once every three months. Do not reuse your ear guard once used. There is a risk of falling off.

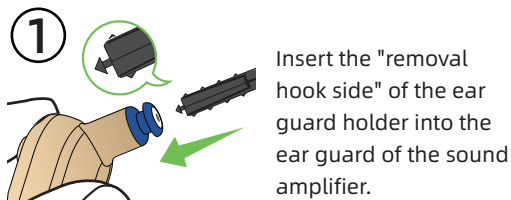

Insert the "removal hook side" of the ear guard holder into the ear guard of the sound amplifier.



Pull out the ear guard holder straight out

The used ear guard sticks to the holder and comes off.

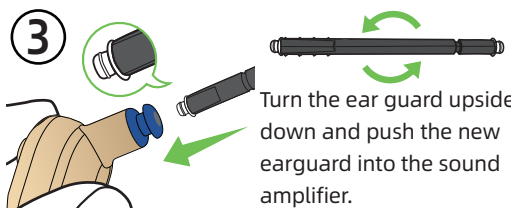

Turn the ear guard upside down and push the new earguard into the sound amplifier.

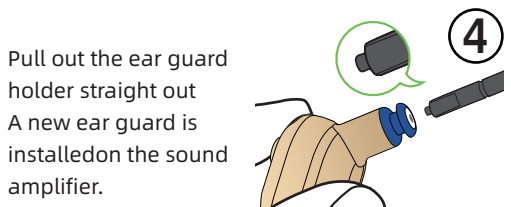

Pull out the ear guard holder straight out

A new ear guard is installed on the sound amplifier.

Maintenance

Keep the sound Amplifier clean at all times. After use, remove ears with the included cleaning brush, wipe off oil and moisture with tissue paper, etc., and keep the product dry.

1. clean the microphone with a cleaning brush.

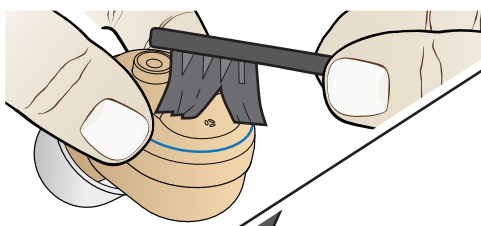

2. clean the sound hole with a cleaning brush.

Troubleshooting

Problem	Possible Solution
Sound is distorted	① Decrease volume. ② Charge the product. ③ Clean the dome.
Sound is weak	① Charge the product. ② Increase volume. ③ Check the dome whether blocked or not.
The product emits whistling sounds	① Reinsert the Earplugs until it fits securely. ② Decrease volume. ③ Clean the Earplugs.
The product does not work	① Change to different size of Earplugs. ② Check whether the microphone is damaged or not. ③ Charge the product.

Consult your Hearing Care Professional or directly contact to us if you encounter further.

Notes and Tips

1. This product is not waterproof, therefore the user must take care to prevent water from entering the product.
2. When not in use for a long time, please put the product in the charging box and charge it once every 1-2 months to avoid damage to the battery.