

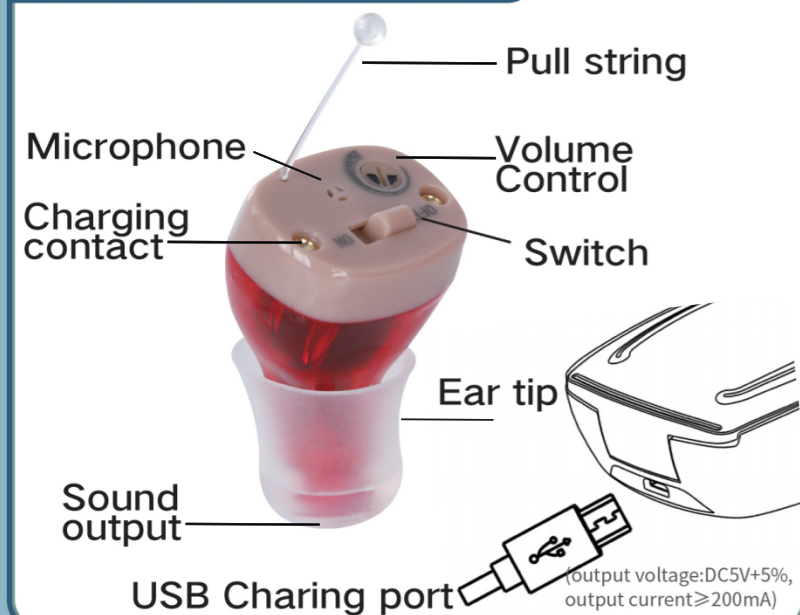

1. Ear tip S/M/L size
2. Cleaning Brush
3. Sound Adjustment Stick
4. USB Charging Cable
5. Earwax Guard



### FEATURES



(output voltage:DC5V+5%, output current≥200mA)

### PRODUCT PARAMETER

Max-OSPL90:	≤110+3dB
HFA-SSPL90:	106±4dB
Peak Gain:	≤28+5dB
HFA Full-on Gain:	≤25±4dB
Eq.Input Noise Level:	≤32dB
Frequency Range:	F1≤350Hz F2≥4500Hz
Harmonic distortion:	≤3%

### POWER ON/OFF

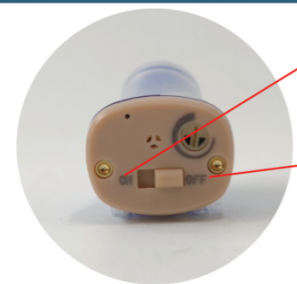

- pull the power switch to the "ON" position and the hearing device is turned on
- Power OFF:** Pull the power switch to the "OFF" position and the hearing device is turned OFF

### SELECT VOLUME

When using it for the first time, please select a suitable ear tip and then slowly increase the volume..



#### Volume Adjustment

Turn clockwise to increase

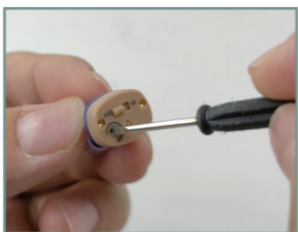

Turn counter clockwise to decrease

### WEAR AND USE

The howling is because there is air or sound leakage between the ear canal and the ear tip of the sound amplifier, so you should choose an ear tip of the size of your ear canal and plug it tightly.

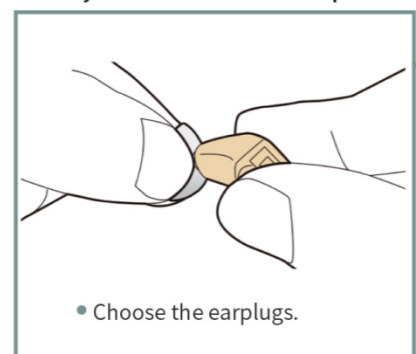

• Choose the earplugs.



• Insert the Hearing device into the ear canal and Be sure to plug it tightly.

### DAILY CLEANING

Keep the sound amplifier clean at all times. After use, remove ears with the include cleaning brush, wipe off oil and moisture with tissue paper, etc., and keep the product dry. Change ear tip regularly, it is recommended to replace new ear tip every 2-3 months

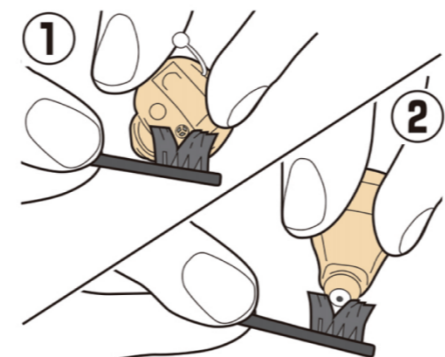

- ① Clean the microphone
- ② Clean the sound outlet

### TROUBLESHOOTING

Malfunction	possible reason	Solution
Silent/ Sound interrupted/ Unstable sound level	low power	Charging the device
	The eardrum head is blocked	Clean the eartips
	Excessive ear contamination	Clean the ear canal or seek medical attention
	Wet hearing device	Use hearing device dryer
	Hearing loss changes	Consult an audiologist
Howling	Damaged hearing aid	Contact the dealer
	Too loud	Adjust it down properly
	Wrong or damaged eartips	Replace the eartip
	Improperly worn machine	Take off and re-wear

### REHABILITATION GUIDANCE

Hearing device can help you hear many sounds you have never heard before. Therefore, when using a hearing device for the first time, the sound may sound uncomfortable. It is just normal! In fact, hearing device have an adaptation process. They adapt slowly to achieve the best listening effect. The time varies from person to person. The following is a rehabilitation plan for first-time users:

- The first stage (first week)  
Wear it for 1 to 2 hours a day. It is recommended that you wear it in a relatively quiet environment to familiarize and distinguish various sounds
- The second stage (second week)  
Wear it for 4 to 8 hours a day, you can wear your hearing device and walk back and forth in a relatively quiet environment to listen
- The third stage (the third week)  
You can wear hearing device to public areas. You can also talk to your friends.
- Fourth stage (fourth week)  
You can prepare to travel, go to supermarkets, restaurants, attend concerts or watch videos. Then you will find a lot of fun in life because You have regained a new voice.

### HOW TO RALPLACE THE EARWAX GUARD

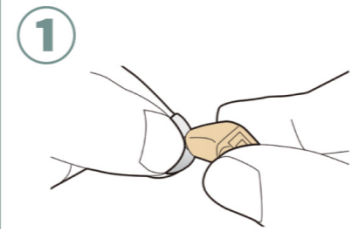

- Please replace the ear guard once every 3 months. Do not reuse your ear guard once used. There is a risk of falling off.

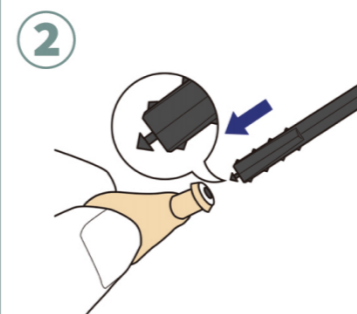

- Insert the "removal hook side" of the ear guard holder into the ear guard of the hearing device.

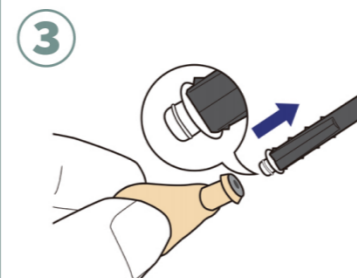

- Pull out the ear guard holder Straight out  
The used ear guard sticks to the holder and comes off.



- Turn the ear guard upside down and push the new ear guard into the hearing device.
- Pull out the ear guard holder straight out  
A new ear guard is installed on the sound amplifier.

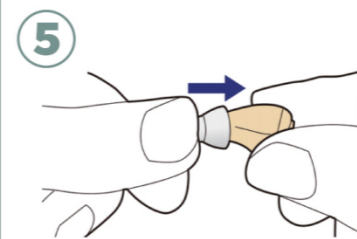

- Wear eartips Make sure that the ear guard is correctly installed.



**FORCE** Before using the sound amplifier, make sure that the ear guard is correctly installed.

### HOW TO CHARGE

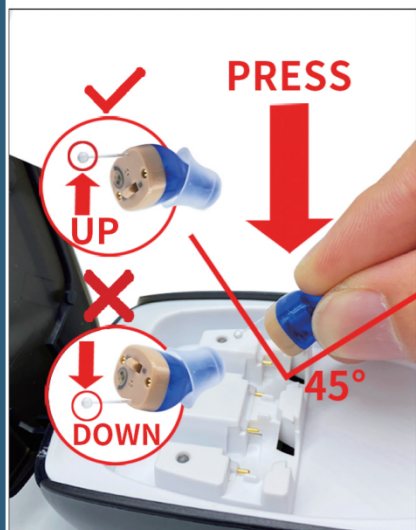

- Insert the machine panel into the charging slot at an angle of 45° to start charging.
- Hold the tip of the eardrum, take out the product at an angle of 45°, and End charging.
- The full charging time is about 6 hours.

### CHARGING INSTRUCTIONS

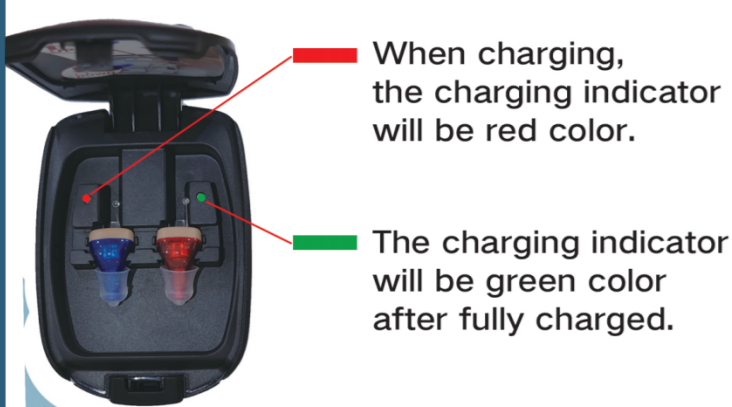

When charging, the charging indicator will be red color.

The charging indicator will be green color after fully charged.